



US Army
Corps of Engineers
St. Louis District



Gateway to Excellence

IOWA Army Ammunition Plant RESTORATION ADVISORY BOARD

FUSRAP Update

22 April 2008



US Army
Corps of Engineers
St. Louis District

FUSRAP Progress Report



Gateway to Excellence

- **Draft Remedial Investigation Report Under Review by Regulators**

- **Draft RI Report published February 8, 2008**
- **RI Report covers:**
 - **Firing Sites Area**
 - **Yard C**
 - **Yard G**
 - **Yard L**
 - **Yard E (portion)**
 - **Yard F (portion)**
 - **Warehouse 3-01**
 - **Area west of Line 5B**



US Army
Corps of Engineers
St. Louis District

FUSRAP Progress Report



Gateway to Excellence

Remedial Investigation Preliminary Findings

- Yard L – Sampling complete; no further action planned.
- Yard G – Sampling complete; no further action planned.
- Yard C – Sampling complete; no further action planned.
- Warehouse 301 - Survey complete; no further action planned.
- Yard E (portion) -- Sampling complete; no further action planned.
- Yard F (portion) -- Sampling complete; no further action planned.
- Area West of Line 5b - Sampling complete; no further action planned.
- Firing Site 1 & 2 – Radiological contamination identified adjacent to the road; further evaluation required.
- Firing Site 3, 4, & 5 – Radiological contamination identified adjacent to the loading dock at FS-5; further evaluation required.
- Firing Site 6, 7, & 8 – Radiological, explosive, and metals contamination identified; further evaluation required.
- Firing Site 12 – Radiological contamination identified; further evaluation required.

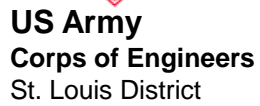

Gateway to Excellence

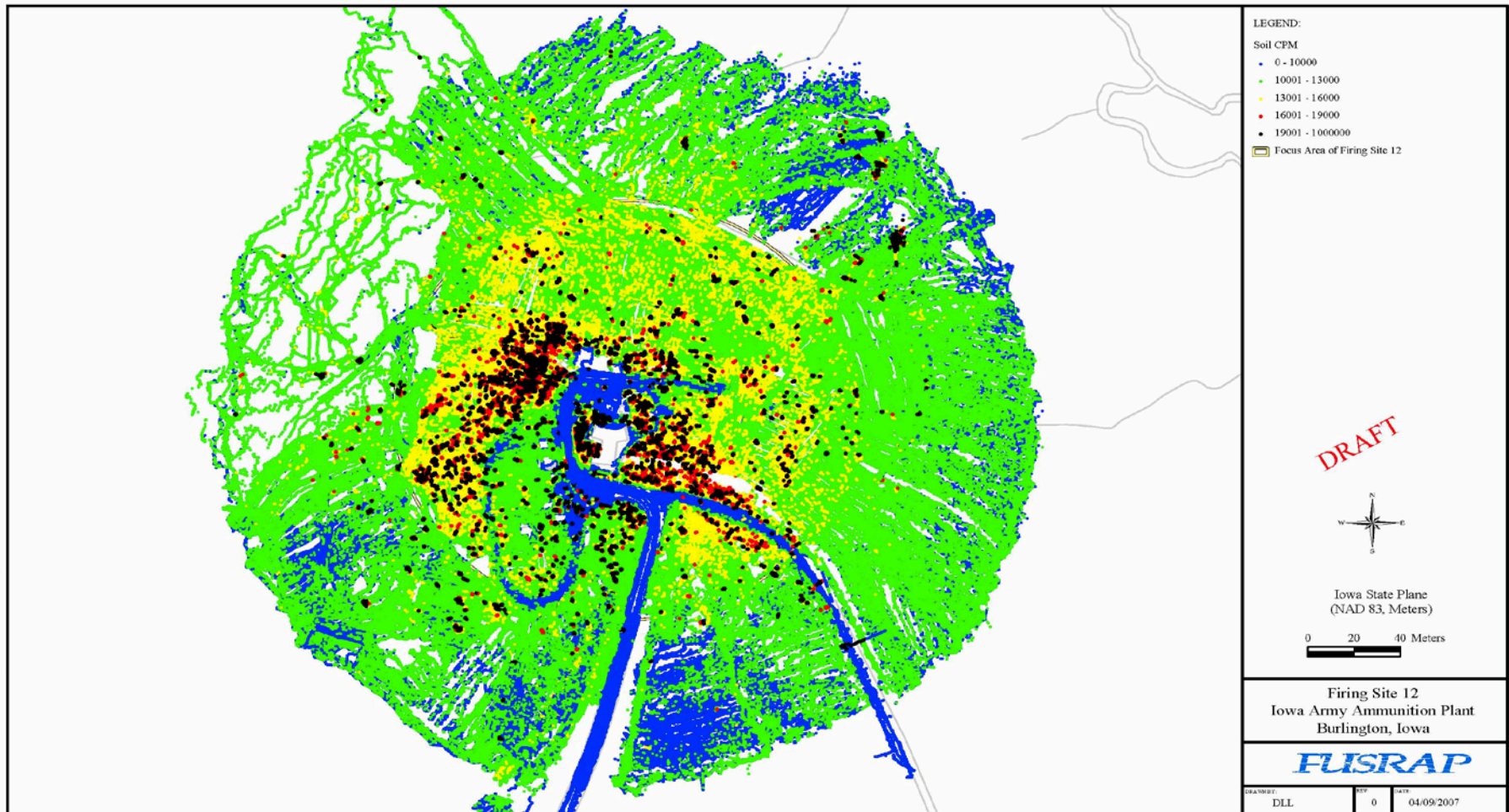

IAAAP Firing Site 12 Gamma Walkover Survey



US Army
Corps of Engineers
St. Louis District

Isolated DU Locations at Firing Sites



Gateway to Excellence

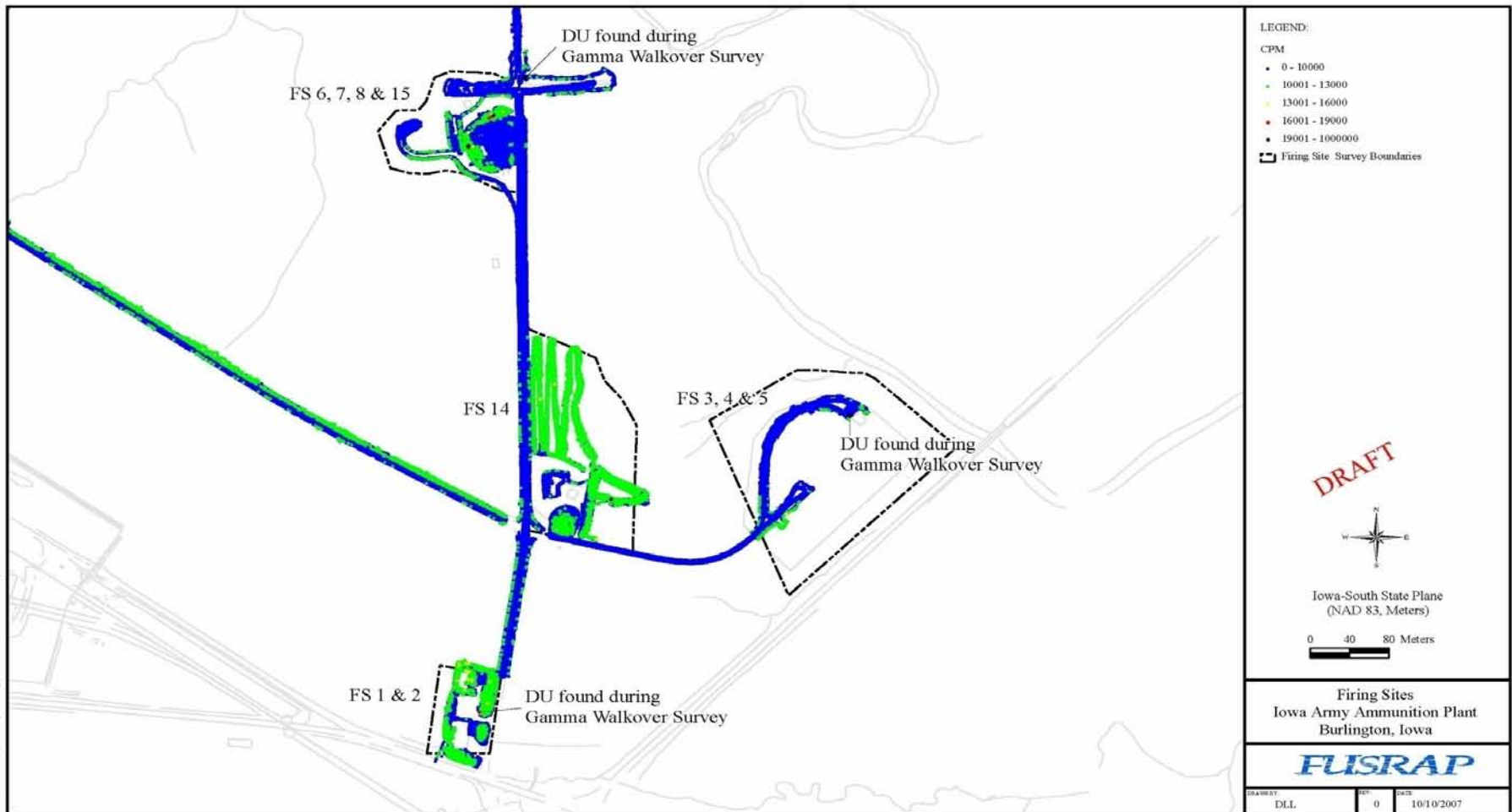

IAAAP Firing Sites 1-6 Gamma Walkover Survey

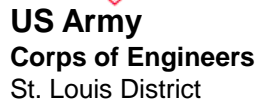

Gateway to Excellence

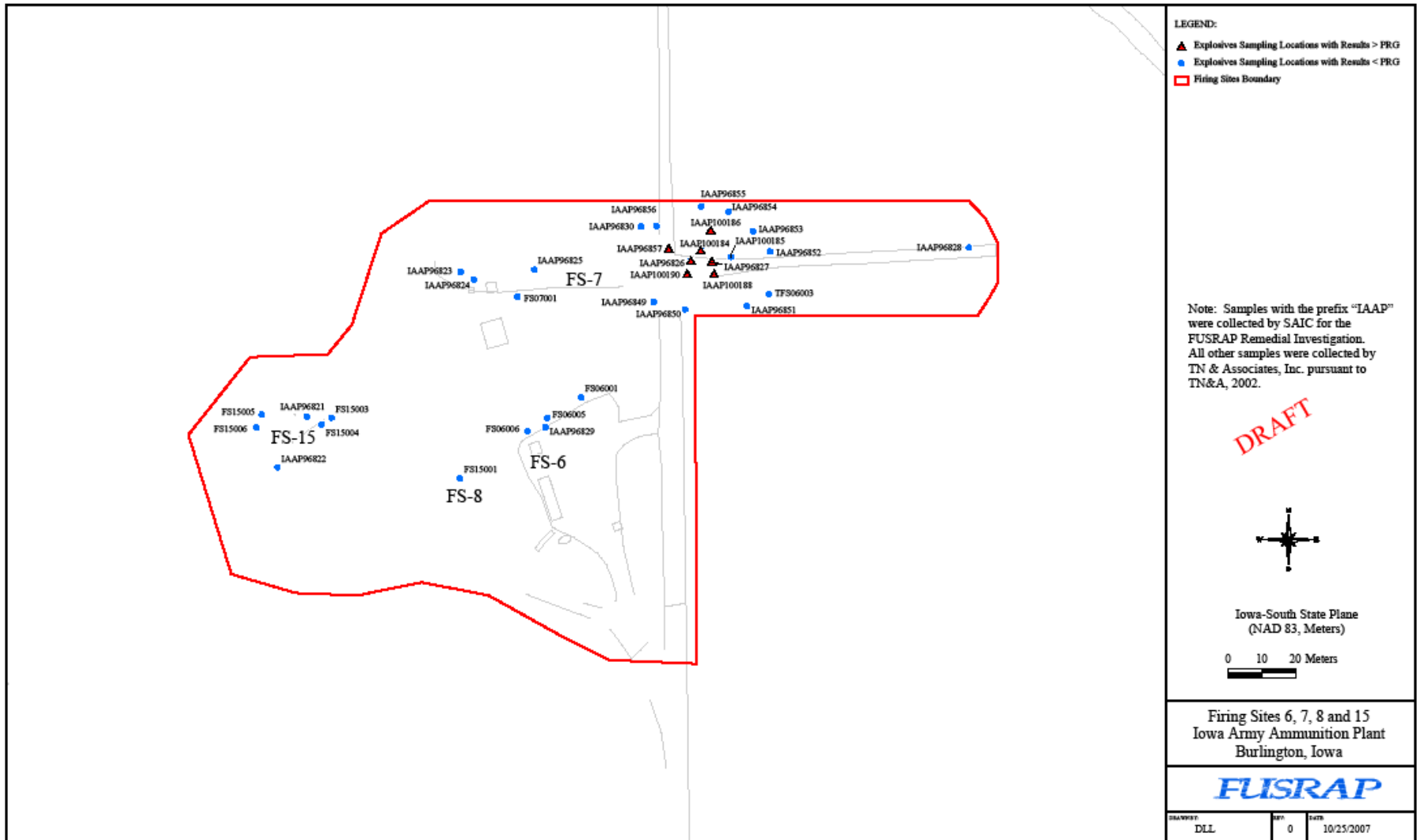



US Army
Corps of Engineers
St. Louis District

Metals Constituents at FS-6 Area



Gateway to Excellence

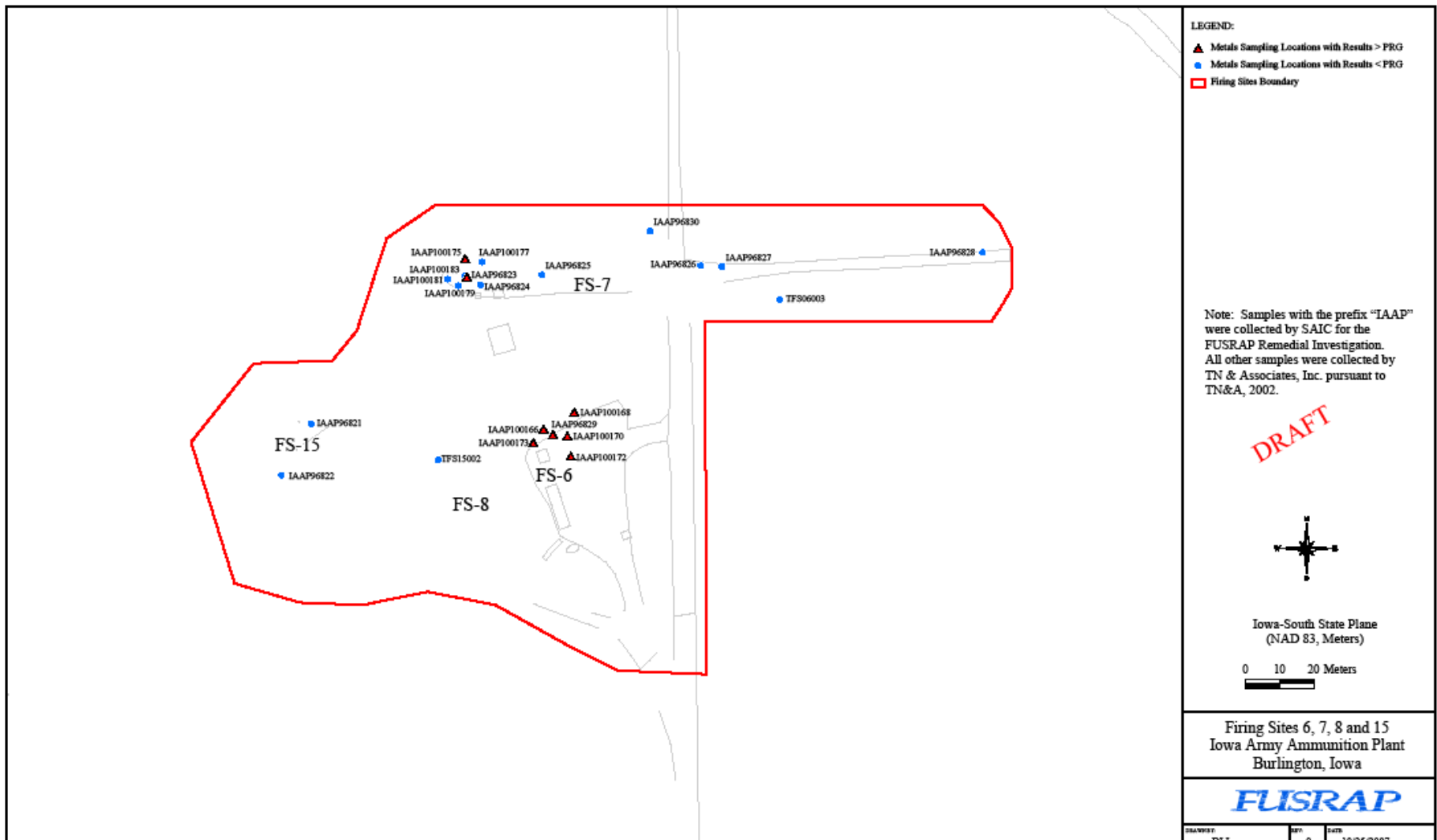



US Army
Corps of Engineers
St. Louis District

RI Preliminary Summary



Gateway to Excellence

- **No DU found at:**
 - Yard C
 - Yard G
 - Yard L
 - Yard E (portion)
 - Yard F (portion)
 - Area west of Line 5b
 - Warehouse 3-01
- **Isolated DU pieces found in soil at:**
 - FS 1 & 2
 - FS-5
 - FS-6 Area
- **Widespread DU pieces found in soil at:**
 - FS-12
- **Chemical constituents (metals and explosives) at levels above PRGs were found in soils at:**
 - FS-6 Area (FS-6, 7, 8)



US Army
Corps of Engineers
St. Louis District

Line 1 and WBP (South)



Gateway to Excellence

- Remedial design underway
 - Line 1: No DU in soil. Found metals, explosives, SVOCs and PCBs at levels greater than ROD RGs.
 - WBP (South): No DU in soil. Found metals and explosives at levels greater than ROD RGs.



US Army
Corps of Engineers
St. Louis District

Line 1 Explosives



Gateway to Excellence

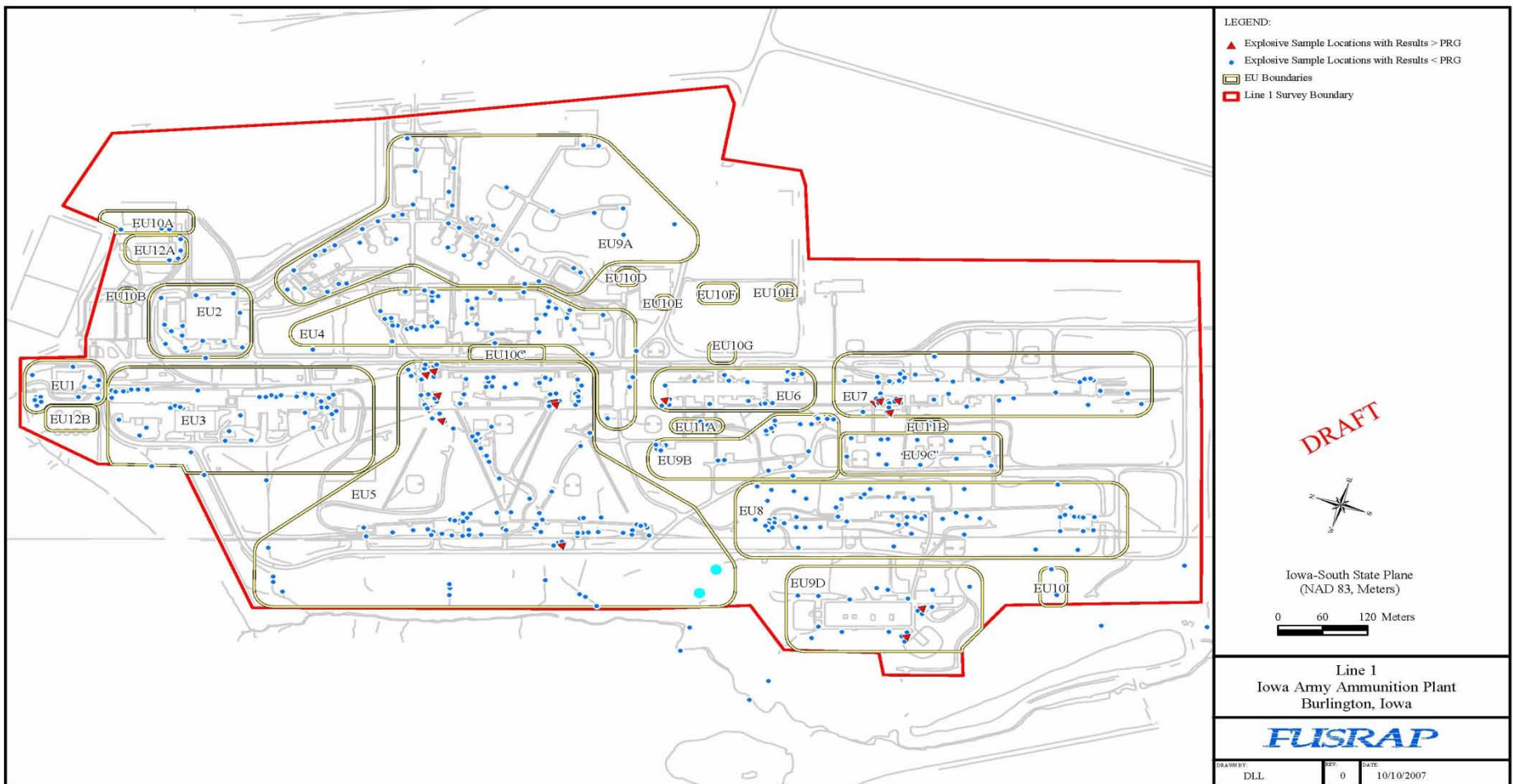

IAAAP Line 1 Explosive Sample Locations



US Army
Corps of Engineers
St. Louis District

Line 1 Metals



Gateway to Excellence

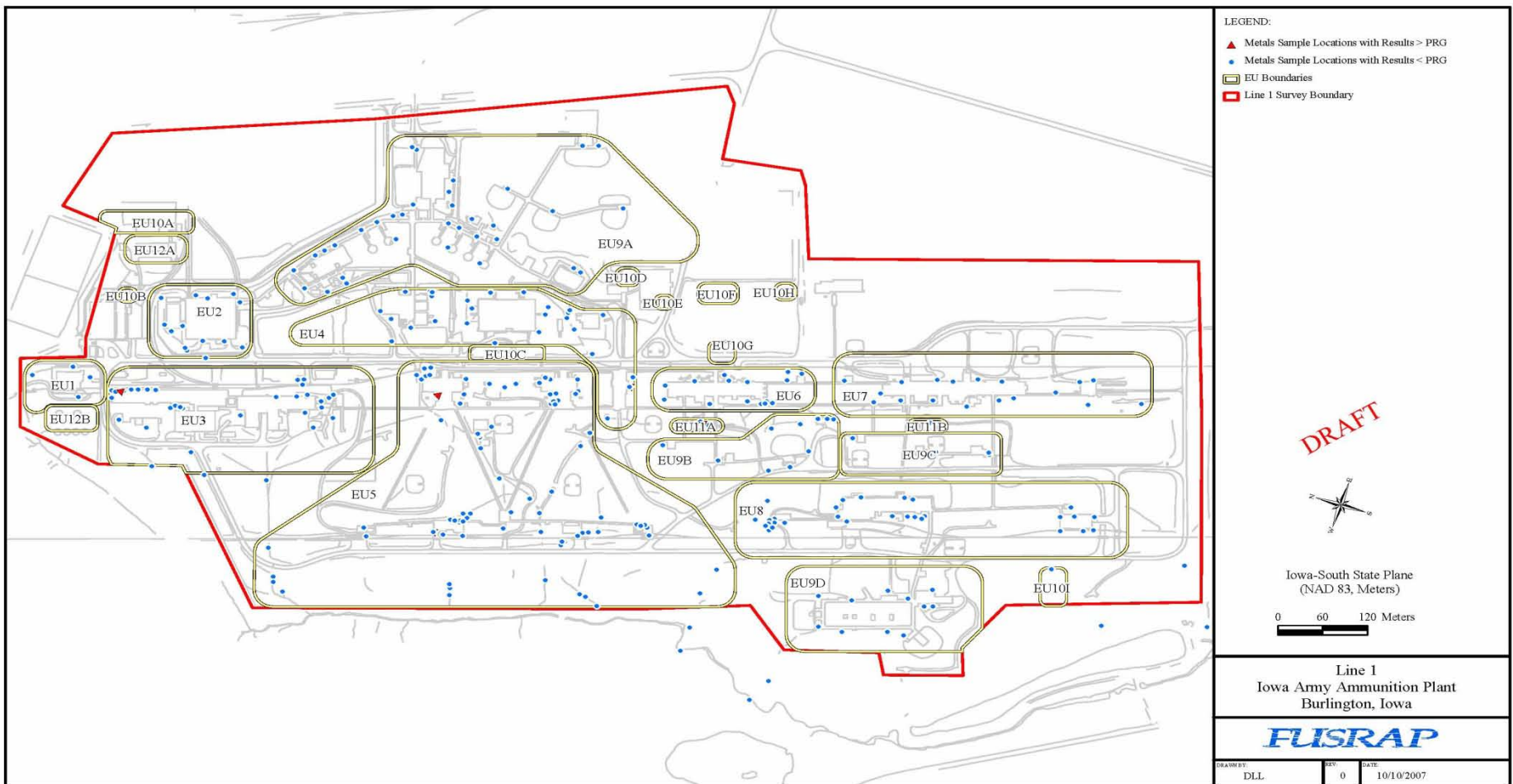



US Army
Corps of Engineers
St. Louis District

Line 1 PCBs



Gateway to Excellence

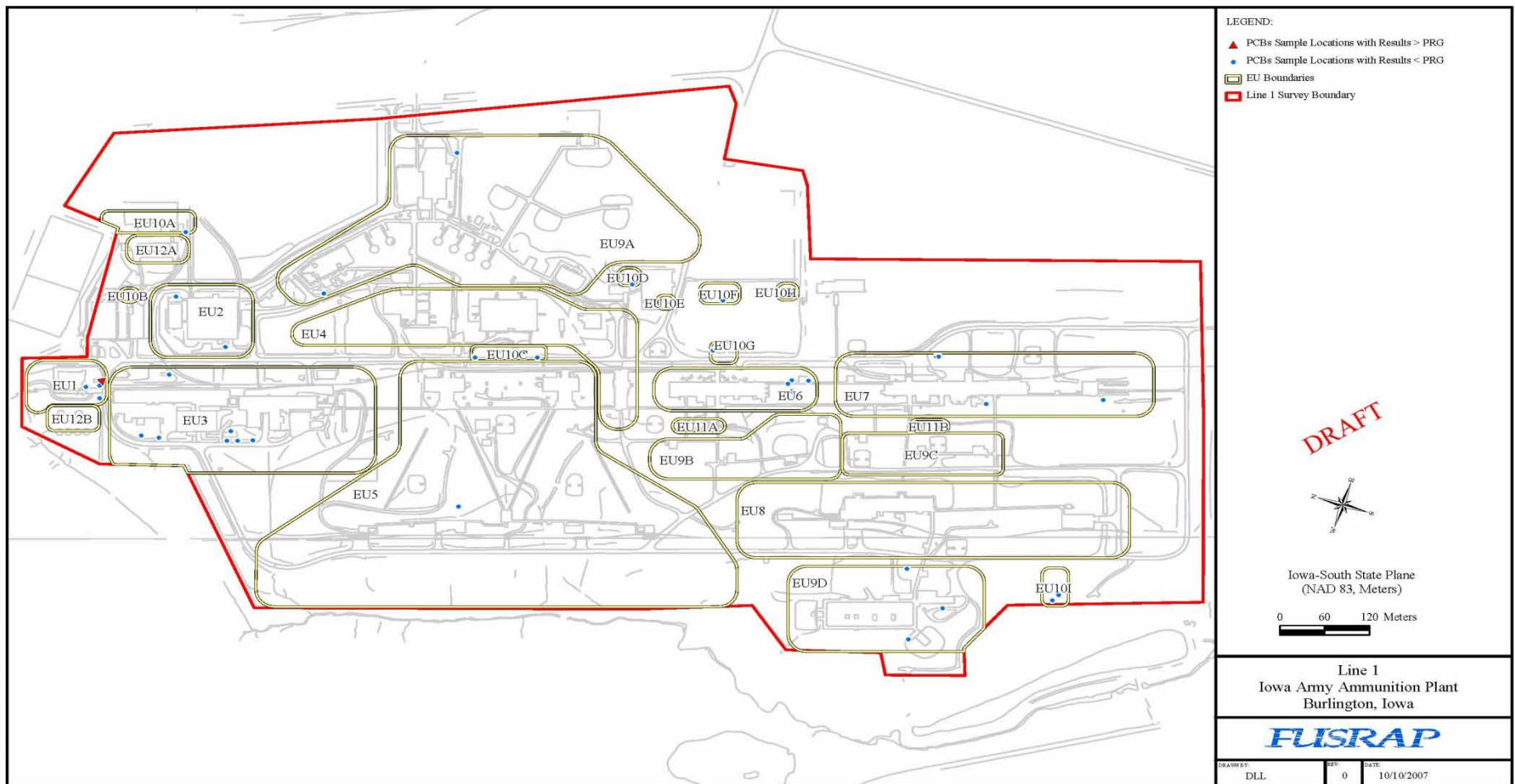



US Army
Corps of Engineers
St. Louis District

Line 1 SVOCs



Gateway to Excellence

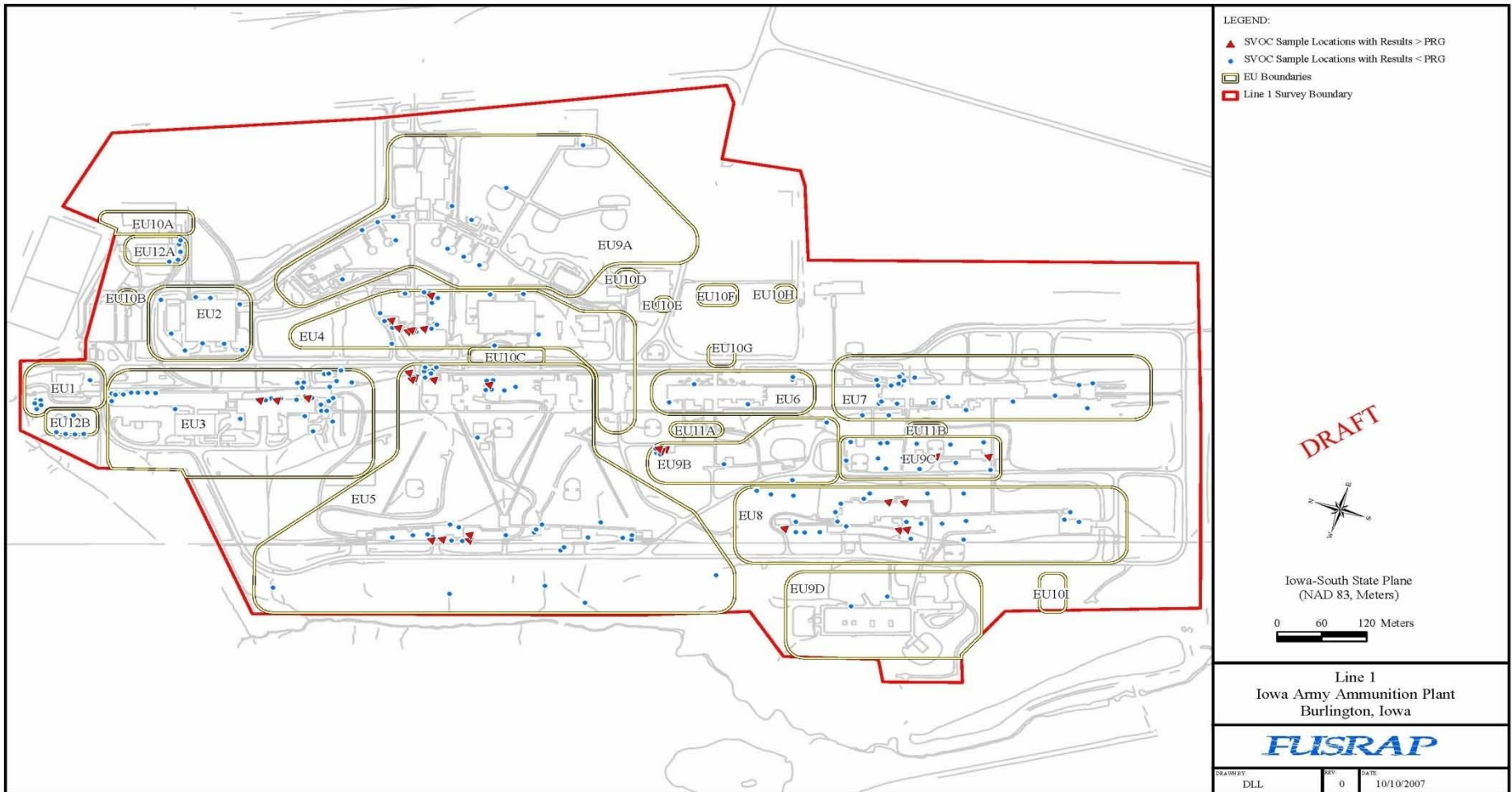

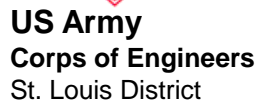

Gateway to Excellence

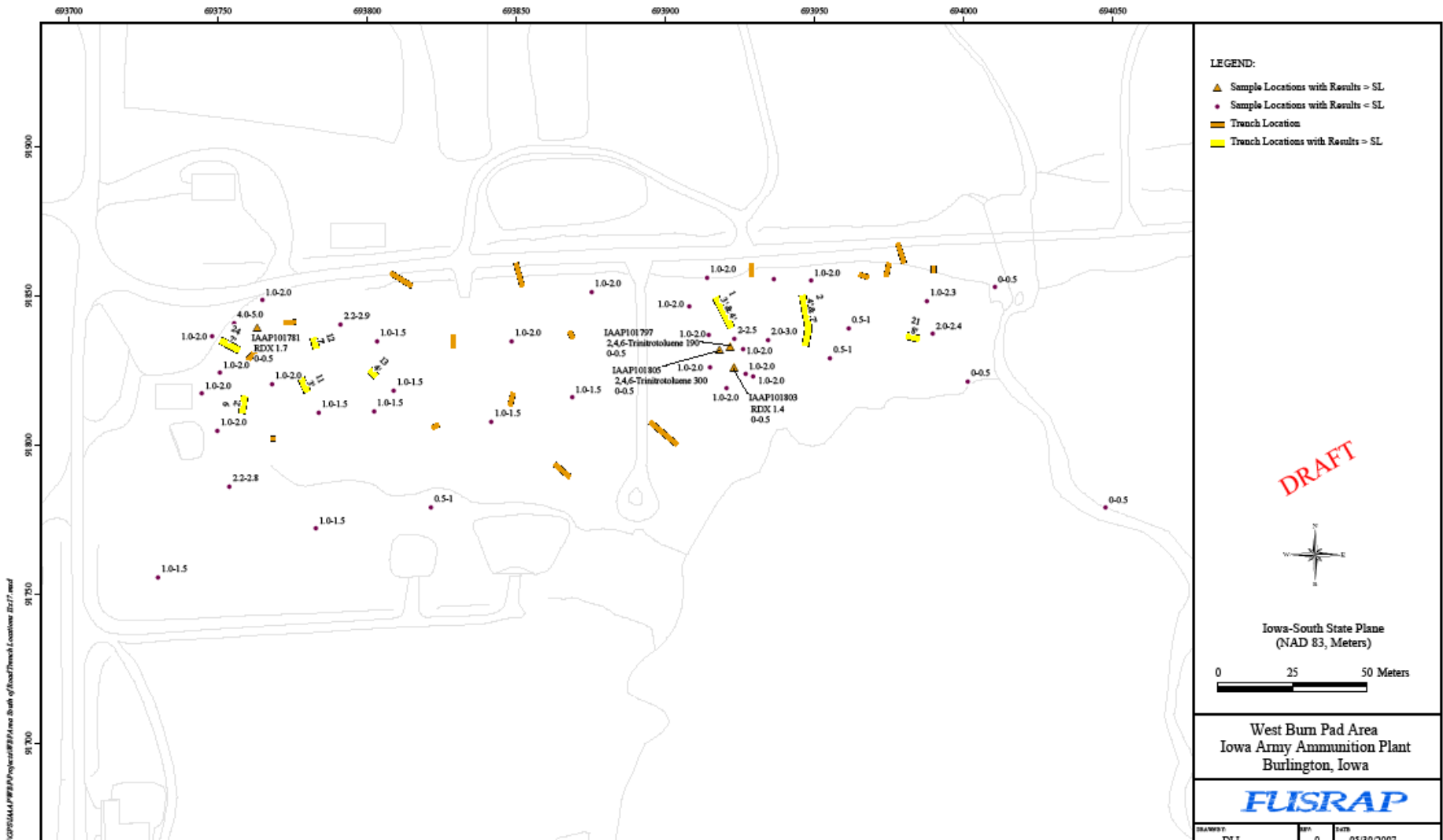



US Army
Corps of Engineers
St. Louis District

FUSRAP Progress Report



Gateway to Excellence

Work Planned for Next Three Months

- Receive/resolve regulator comments on Draft RI Report.
- Submit Draft Remedial Design for regulator review



US Army
Corps of Engineers
St. Louis District

Questions



Gateway to Excellence

Questions? Questions? Questions?

Questions? Questions?

Questions? Questions?

Questions? Questions?

Questions? Questions?

Questions? Questions?

Questions? Questions?